



WATER PRESSURE TEST GAUGES

MODEL BRWT

FEATURES:

The Model BRWT water pressure test gauge from Blue Ribbon Corporation is a utility gauge that adapts directly to a water tap to accurately and cost-effectively measure line and system pressures. The $\frac{3}{4}$ " Female hose swivel fits all standard hose connections.



Model BRWT300

SPECIFICATIONS:

- Dial Size: 2"
- Range: 0-10, 0-30, 0-160, 0-300 PSI
- Connection: $\frac{3}{4}$ " FHT Brass Swivel
- Accuracy: 3-2-3%, (ASME B40.1, Grade B)
- Max Pointer Standard

PART NO.	RANGE	Dial Size	Maxi Pt.
BRWT-10MX	0-10 PSI	2.5"	Yes
BRWT-30MX	0-30 PSI	2.5"	Yes
BRWT-160MX	0-160 PSI	2.5"	Yes
BRWT-300	0-300 PSI	2.0"	Yes

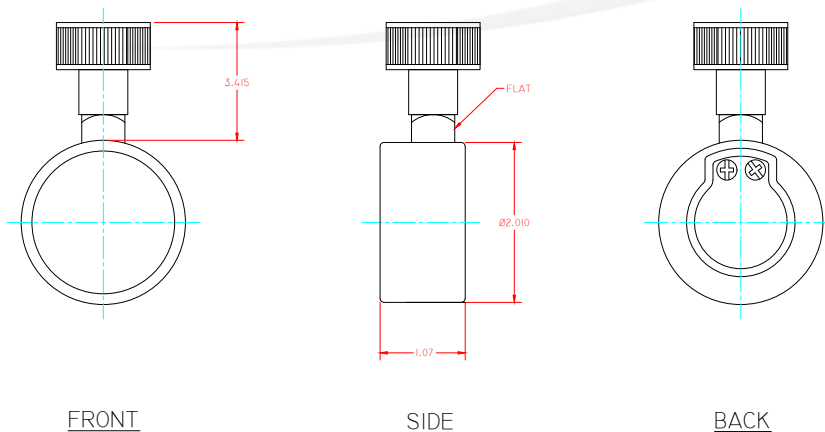

BRWT300
2" WATER TEST GAUGE
IN DRAWING SAMPLE

BR5SL-G-012
REV-E