



FLUSH SUBMERSIBLE LEVEL TRANSMITTER

MODEL BR313F



Model BR313F
Flush Submersible Level Transmitter

FEATURES:

- Large flush ceramic diaphragm
- 0 to 20 INWC thru 0 to 285 PSI
- Corrosion resistant, leak-proof construction
- PTFE, PUR or PE cable with FKM flourine seal
- Designed to 500 PSI external pressure
- Flush design saves cost and down time by eliminating sensor clean up

APPLICATIONS:

- Submersible pump lift station level monitoring
- Water tanks and reservoirs
- Process sumps
- Water and wastewater level monitoring
- Water recycling
- Sludge or slurry levels
- Other aggressive media

PRODUCT OVERVIEW:

Model BR313F utilizes a flush 1.575" diameter ceramic sensor that inhibits grease and biosolid buildup typically found in water treatment level applications. This flush ceramic design saves cost by eliminating sensor clean-out found with many other non flush designs. The corrosion-resistant 304SS construction, and an integrated hydrophobic breather vent help provide years of maintenance-free service.

FIELD OPTIONS:

- PTFE, PUR, or Polyurethane jacketed cable
- Titanium, or 316L SS housing



FLUSH SUBMERSIBLE LEVEL TRANSMITTER

DIMENSIONAL DRAWING

All dimensions are in inches (mm)

STANDARD WIRING

WIRE	MODEL 313F
RED	+EXC/SIG
BLK	-EXC/SIG
GRN	N/C
WHT	N/C
SHIELD	OPEN

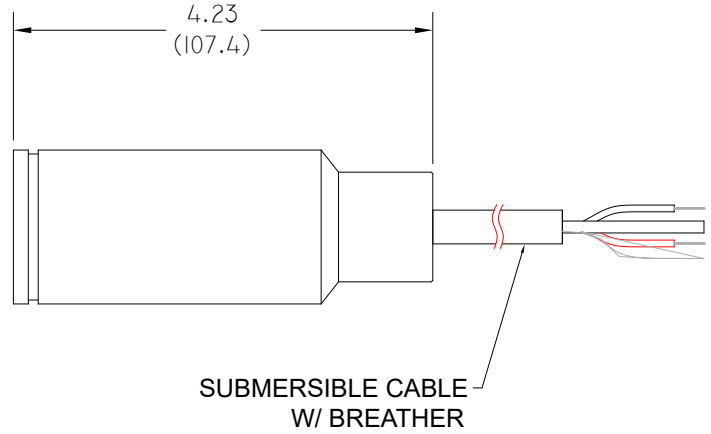
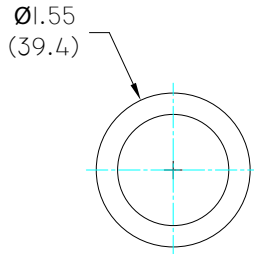

REFERENCE SPECIFICATIONS

<p>ELECTRICAL</p> <ul style="list-style-type: none"> • Supply Voltage: 12 to 36 Vdc • Output Signal: 4-20 mA output • Circuit Protection: Short circuit or reversed wired – Indefinite • Load Resistance: 100 Ω max. at 50 Vdc excitation • Response Time: ≤3 ms to 90% • Connection: ½" NPT (M) w/8 ft 18 AWG Hytrel® jacketed cable (Tefzel® jacketed cable optional) 	<p>MECHANICAL</p> <ul style="list-style-type: none"> • Zero Balance and FSO: ±0.75% FSO @ +70 °F • Process Connection: Flush ceramic • External Pressure: Rated to 500 PSI (1,153 ft WC) max. • Proof Pressure: 1.5X FSO • Burst Pressure: 4X FSO • Approximate Weight: 10 oz (240 g) nominal, options may increase weight • Diameter: 1.575"
<p>MATERIALS OF CONSTRUCTION</p> <ul style="list-style-type: none"> • Housing: 304 SS (Optional 316L or Titanium) • Sensor: Ceramic Al2O3 - 96% • Cable: PTFE, PUR or PE available • Cable Seal: FKM flourine 	<p>PRESSURE RANGES</p> <ul style="list-style-type: none"> • 20 INWC to 0-285 PSI
<p>STATIC ACCURACY (RSS) (HYSTERESIS, NON-LINEARITY & REPEATABILITY @ +70 °F)</p> <p>Standard: ±0.5% FSO</p> <p>Improved: ±0.25% FSO, and ±0.1% FSO</p> <p>Zero & Span Balance: ±0.1% FSO @ +70 °F</p>	<p>THERMAL SPECIFICATIONS</p> <ul style="list-style-type: none"> • Compensated: +14 °F to +158 °F (-10 °C to +70 °C) • Operating: -4 °F to +158 °F (-20 °C to +70 °C) • Storage: -40 °F to +180 °F (-40 °C to +82 °C) • Effect on Zero/Span: <±2.0% FSO/100 °F at full

All specifications are for reference purposes only. In the interests of continuous product improvement, all specifications are subject to change without notice. Please contact Blue Ribbon Corporation for assistance with your application.

